

AIR FORCE J-10B / 空軍戰-10B

3D METAL MODEL 3D金屬模型

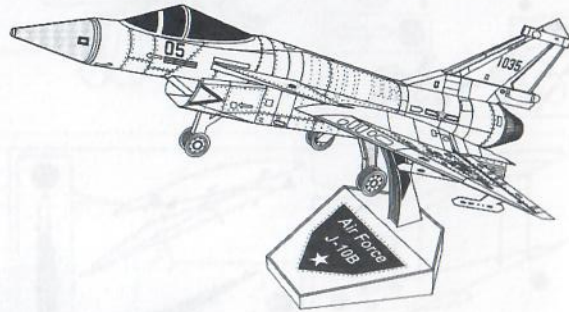

CAUTION / 注意:

- Keep out of reach of children. 請放置于幼童接觸不到的地方。
- Warning, small parts. 請留意細小部件。
- Pay attention to sharp edges when removing pieces from the metal sheet.
取下零件時，請注意邊緣的銳點，避免劃傷。
- Carefully discard the metal sheet after parts have been removed. 零件取下後，小心處理剩餘金屬片。

Insertion tab
插頭

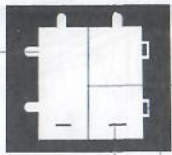

Fold line
彎折線

Insertion holes 插口

To create the best connections 建立穩固的連接的方法:

- Insert tab and bend 90 degrees for most visible areas
插頭穿過插孔後，將插頭最大限度地拉出，並平折成90度角。
- ▲ Insert tab and twist 90 degrees is best in some areas to ensure a tight connection
插頭穿過插孔後，將插頭作90度旋轉扭曲，可在某些部位形成緊密的連接。



Pull and Screw metal tab 90° to tighten
拖出插頭並扭轉鎖緊

Schematic drawing of sheet metals (two pieces of sheet metal).
金屬片示意圖 (有2片金屬)

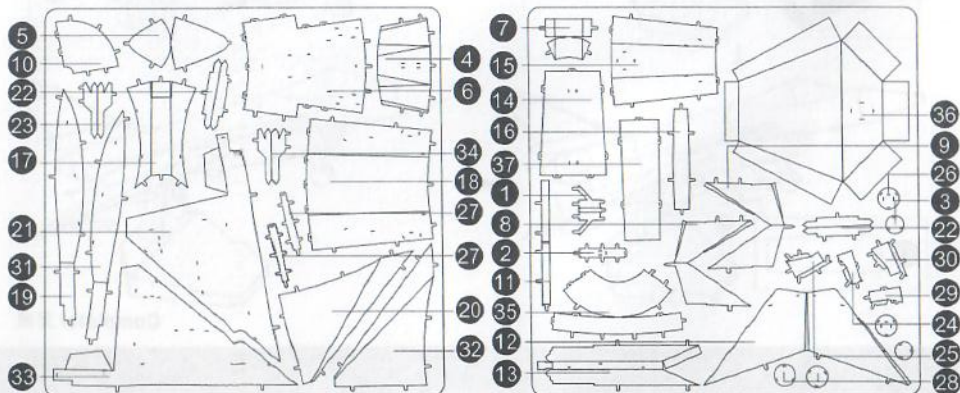

ASSEMBLY METHOD: Follow assembly flow chart. 請按以下示意圖拼裝。

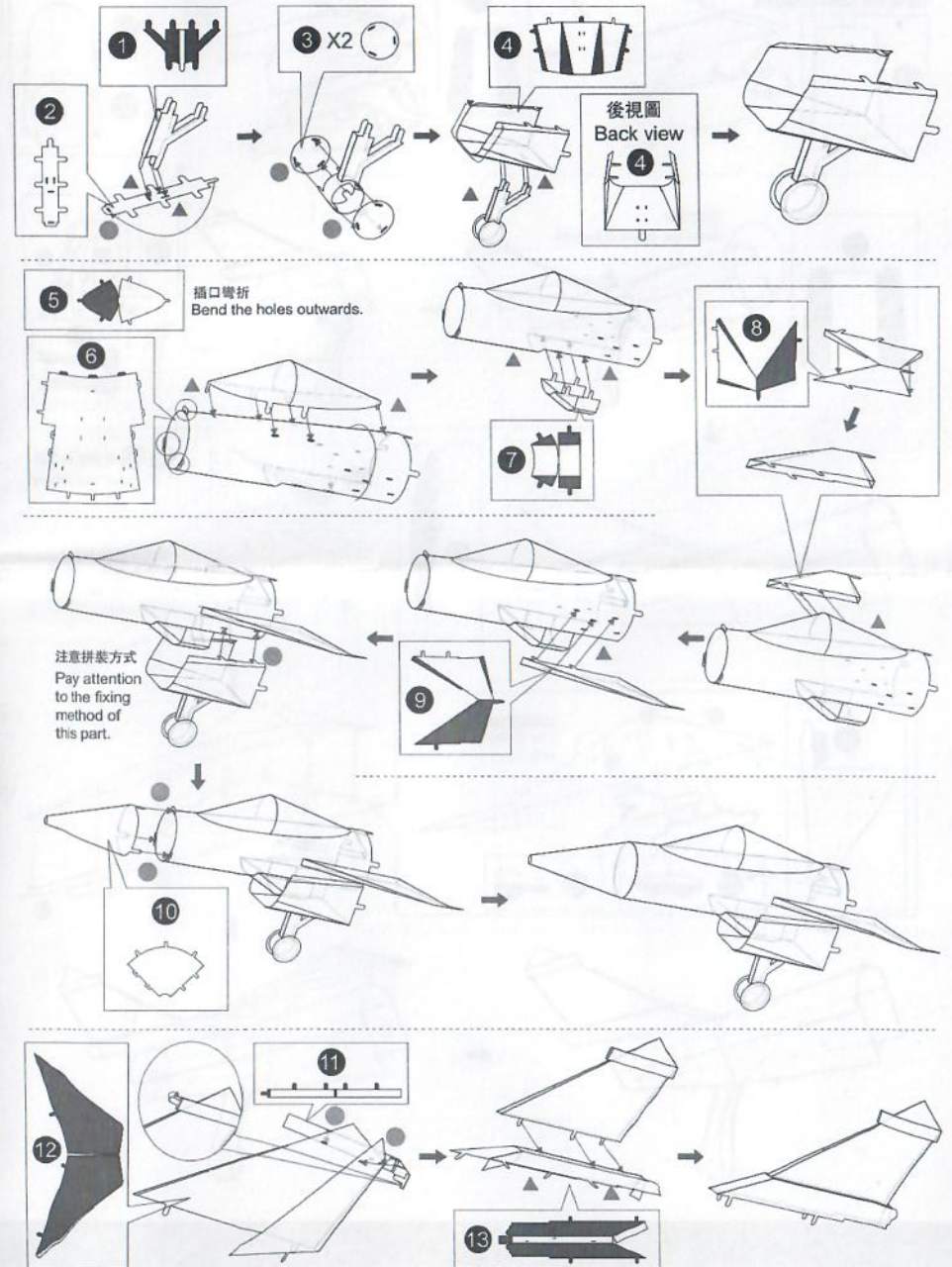

插口彎折
Bend the holes outwards.

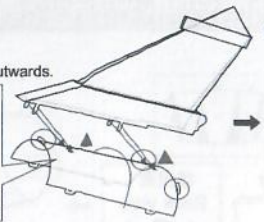

插口彎折
Bend the holes outwards.

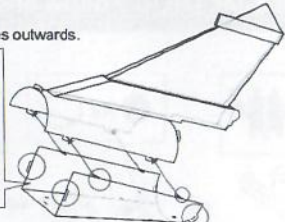

後視圖
Back view

14

15

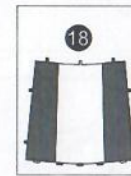

插口彎折
Bend the holes outwards.

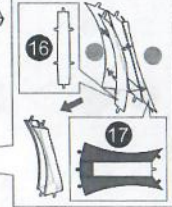
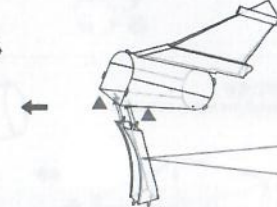
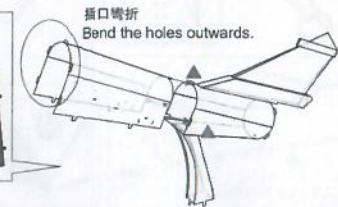

19 20 折面弧形彎折
To curve the shape.



彎曲插脚以適應外折後的插孔。
Bend the tabs to fit the outward holes.

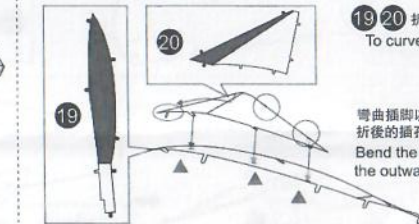
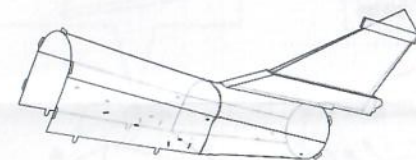

正面花紋朝上
The pattern side up.

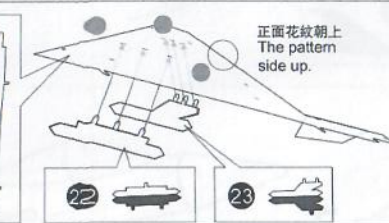

22

23

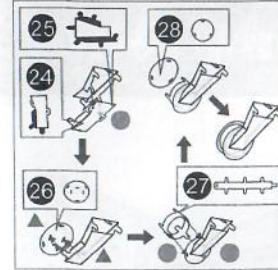
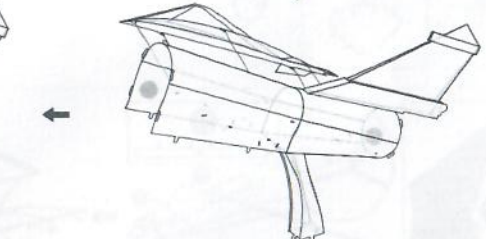
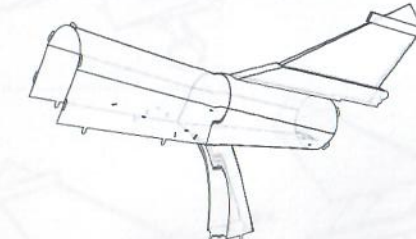

25

24

26

27

28

28

27

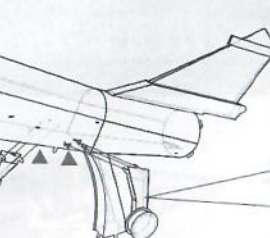

30

29

26

28

28

27

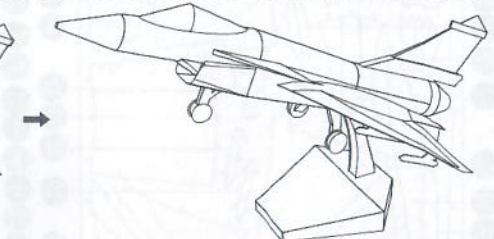
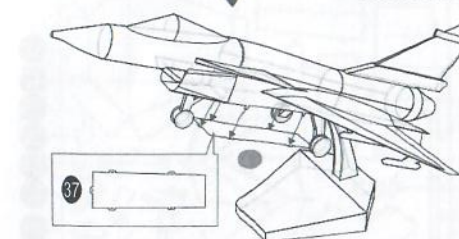
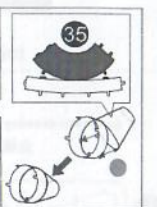
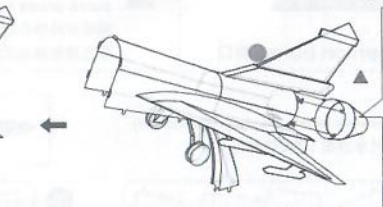
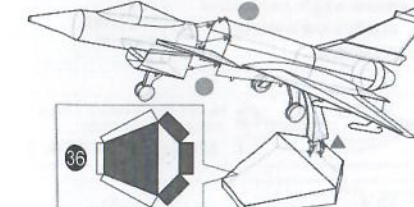
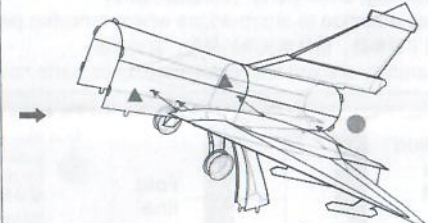
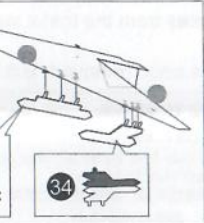
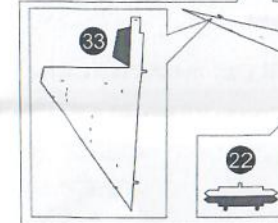
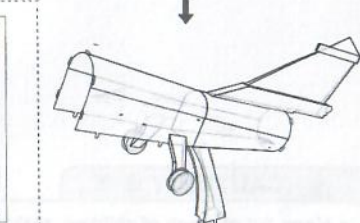
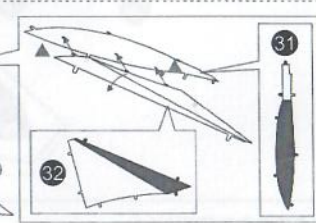
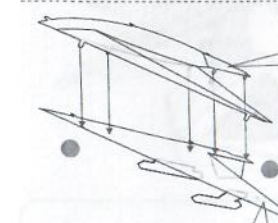
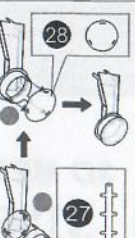

Complete/完成