

3D METAL MODEL

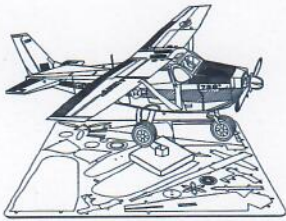

3DJ5041



Insertion holes
Fold lines can be seen as shown here
Insertion tabs are inserted and then folded

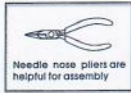

Needle nose pliers are helpful for assembly

To create the best connections

● Insert tab and bend 90 degrees for most visible areas

▲ Insert tab and twist 90 degrees is best in some areas to ensure a tight connection

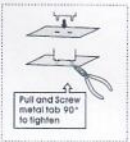

Pull and Screw metal tabs 90° to tighten

Metal sheet

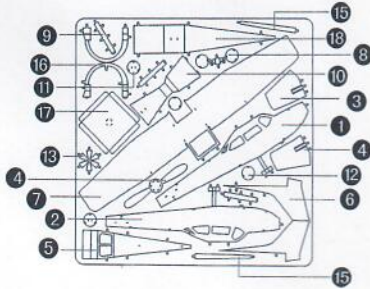

⚠ In order to avoid possible injury from sharp edges, please carefully discard the metal sheet after parts have been removed

Assembly Flow Chart

