

Imperial Star Destroyer™

360° view

Legends:

- E** Engraved side
- NE** Non-engraved side
- Attention point
- Insert tab and bend 90 degrees
- Insert tab and twist 90 degrees

Recommended tools:

- Wire cutters: helpful for taking parts from the metalsheets.
- Tweezers or needle nose pliers: helpful for folding parts, bending and twisting tabs.

Assembly tip:
If needed, slightly twist tabs to hold parts together then untwist and bend them down for a nice finish

Insertion tabs are inserted and then folded
Insertion holes
Fold lines can be seen as shown here

Metal sheets

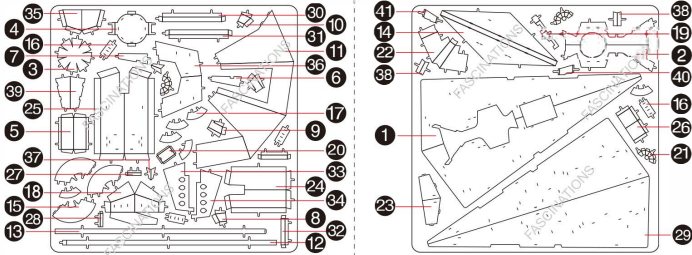

In order to avoid possible injury from sharp edges, please carefully discard the metal sheets after parts have been removed

Assembly Flow Chart

1, 2, 3, 4, 5, 6, 7, 8, 9, 10, 11, 12, 13, 14, 15x3, 16, 17x2, 18

Page 3

18, 19, 20, 21x2, 22, 23, 24, 25, 26, 27, 28, 29

Engraved side faces down

Page 4

30, 31, 32x2, 33, 34, 35, 36, 37, 38, 39, 40, 41

© 2013 Lucasfilm Ltd. & TM. All rights reserved.